



A Strategic Partner with



# PALLET LINE CONVEYOR SYSTEMS

Workpiece Tray  
Conveyor

Transfer Unit  
Curve Unit

Lift & Locate  
Positioning Unit

Lift & Rotate  
Control Unit

Direct Conveyors is a comprehensive solution provider for conveyor systems, covering everything from research and development to sales and automation services. Partnering with Vitrans, a brand with over 70 years of history in pallet conveyors, is a strategic move. With such expertise and experience, the collaboration can likely offer top-notch conveyor solutions for industrial automation needs across diverse industries.

# Company Profile



Production Plant



Production Plant



Production Plant

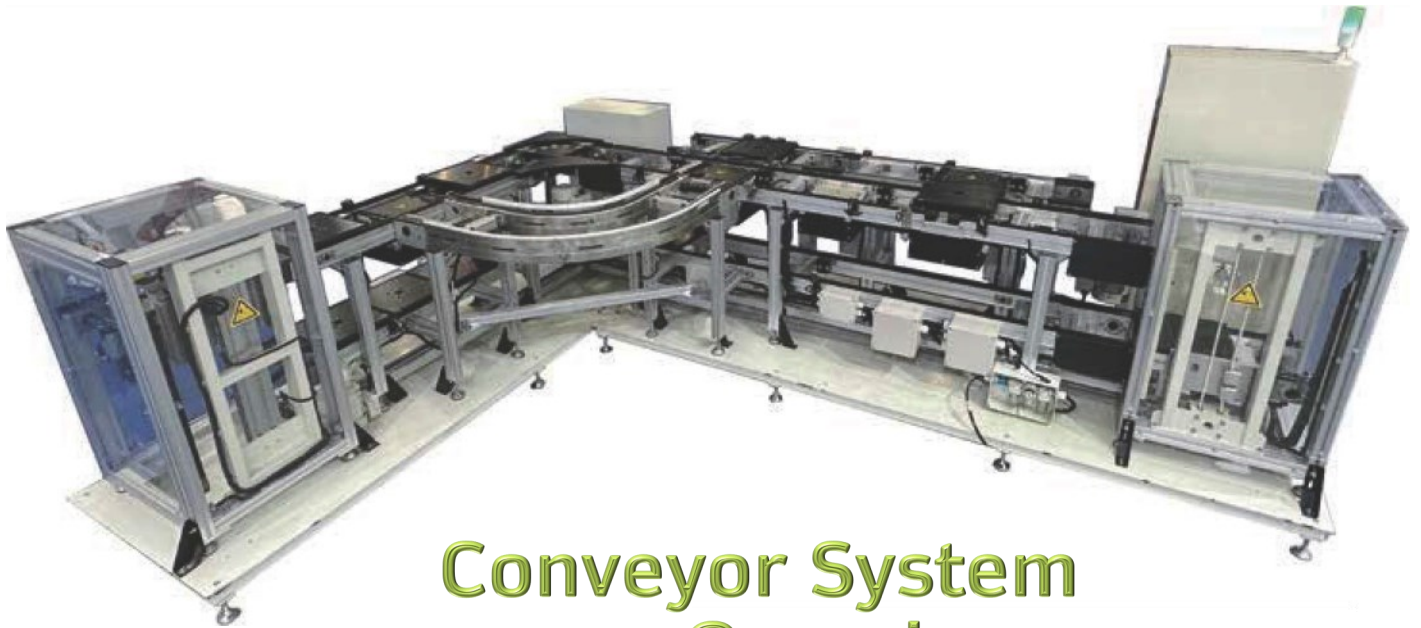

# Conveyor System Overview

**A** Timing Belt Conveyor



**B** Flat Belt Conveyor



**C** Accumulating Steel Roller Chain Conveyor



**D** Accumulating Plastic Roller Chain Conveyor



**E** Flat Top Chain Curve Unit



**F** Servo Elevator



**G** Pneumatic Elevator



**H** Positioning Unit

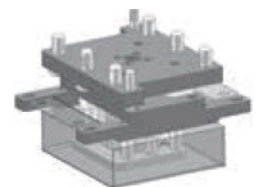

**I** Lift Transfer Unit



**J** Round Belt Curve Unit



**K** Lift & Rotate Unit





## Product Application



Auto Part Assembly  
Line



3C Product Assembly  
Line



Other Application

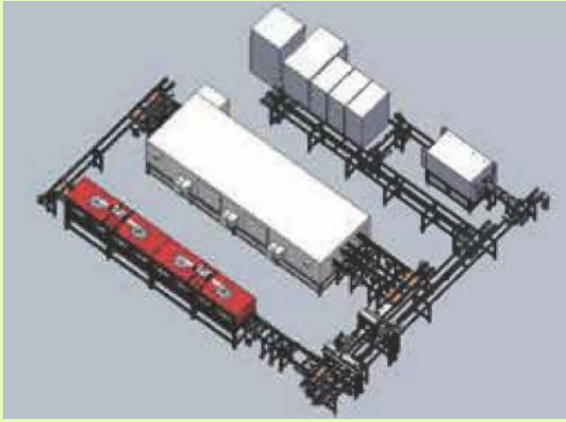

# Multiple Layout Designs

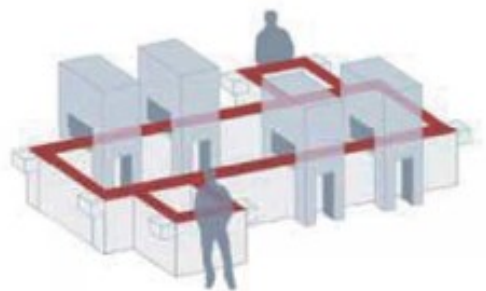
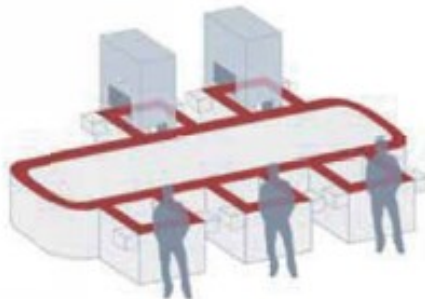
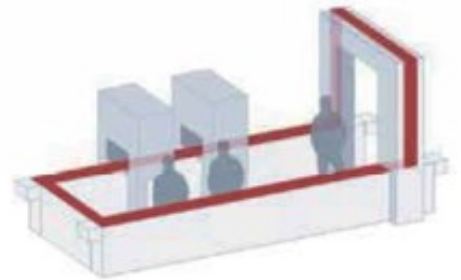
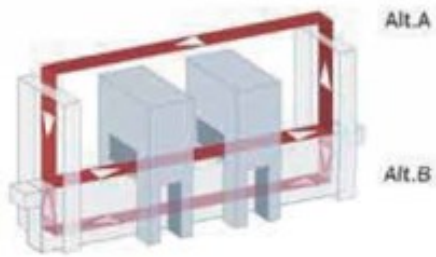
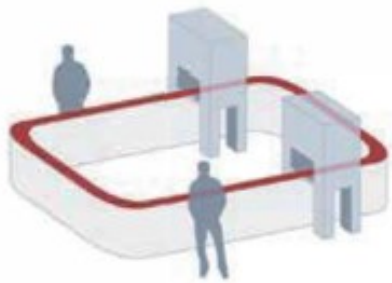

# Product Details

## Flat Belt Conveyors

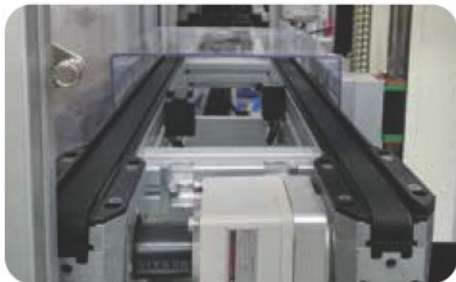
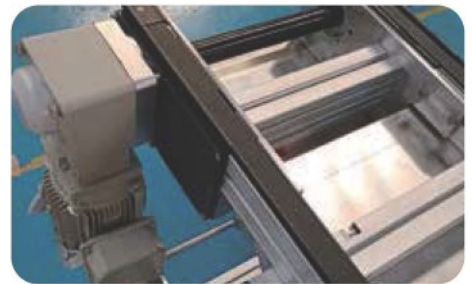
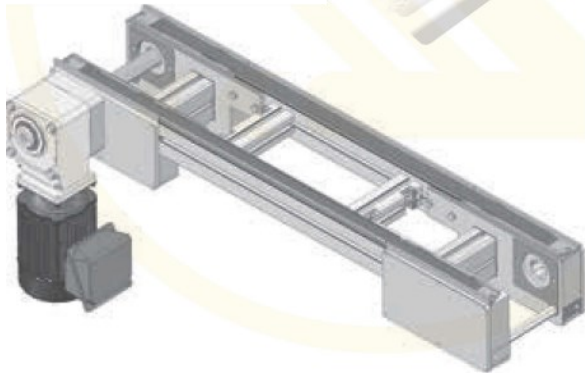

## Timing Belt Conveyors

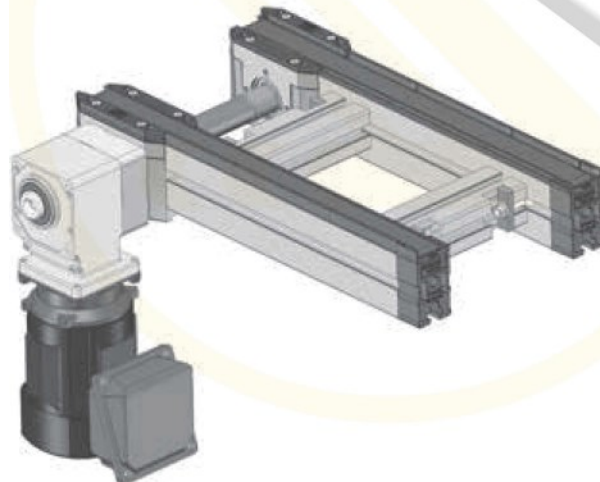

**Accumulating  
Steel Roller  
Chain Conveyors**

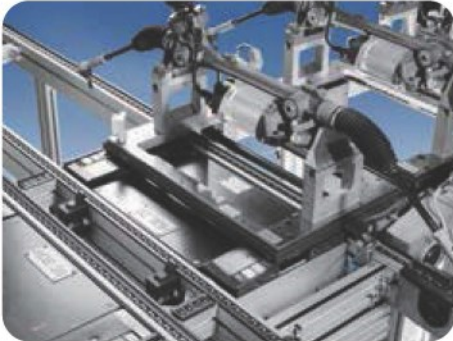
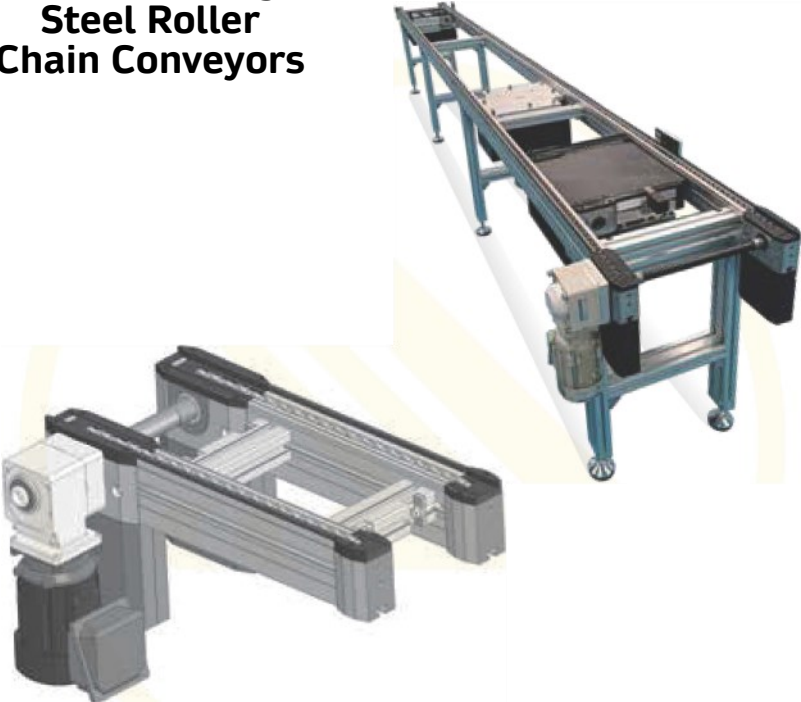

**Accumulating  
Plastic Roller  
Chain Conveyors**

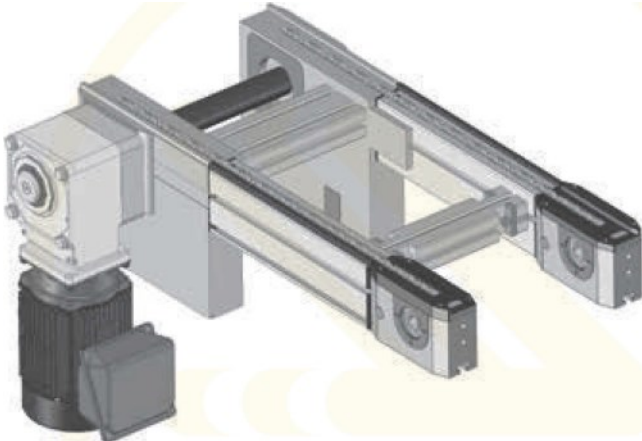

## Assembly Pallets



## Lift & Transfer Units

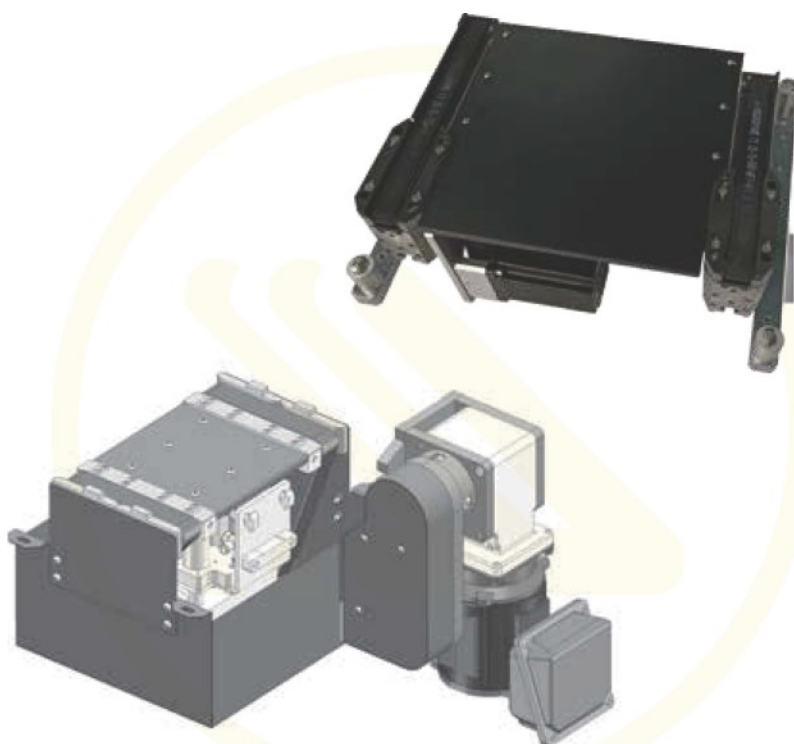

**Round Belt  
90° Curve  
Conveyors**



**Round Belt  
180° Curve  
Conveyors**

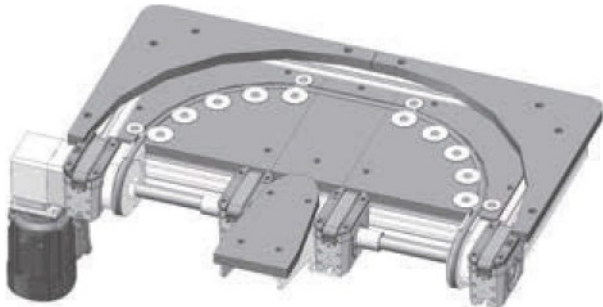

**Flat Top Chain  
90° Curve  
Conveyors**

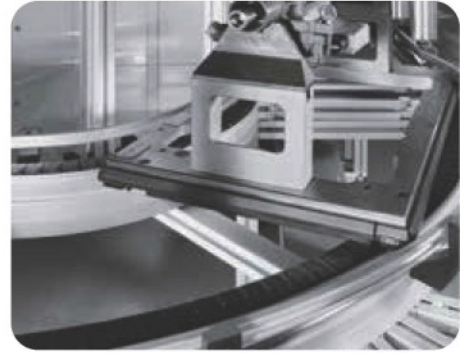
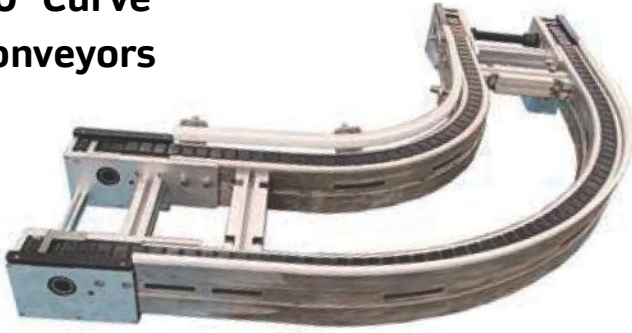

**Flat Top Chain  
180° Curve  
Conveyors**

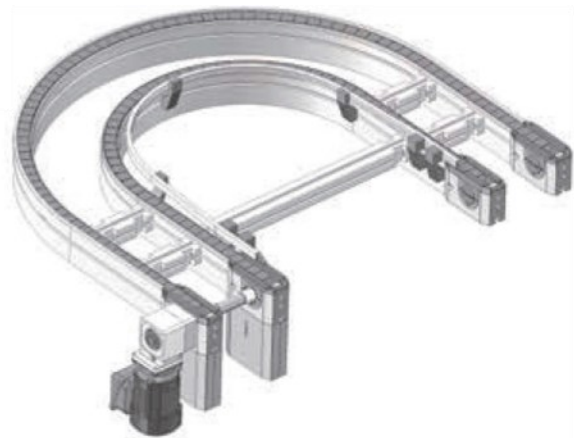

## Elevators



## Other Modules

Lift positioning Unit

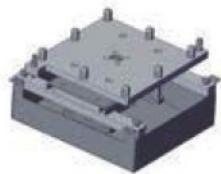

Lift rotating Unit

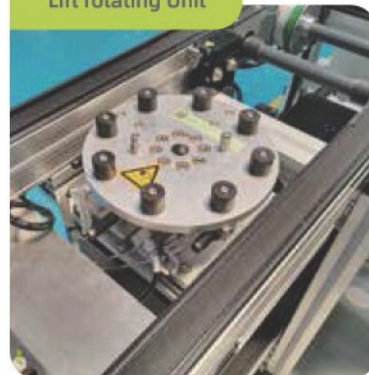

60KG Stopper- Damping



150KG Stopper- Damping



250KG Stopper -Non damping



Returning Stopper

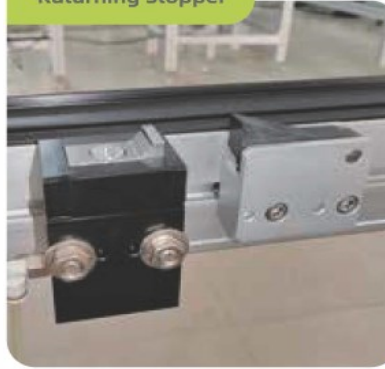

Damper-one way

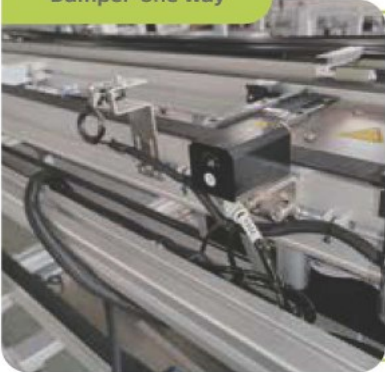

Damper- two ways

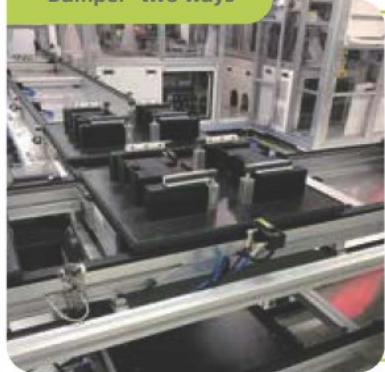

Sensor bracket-side

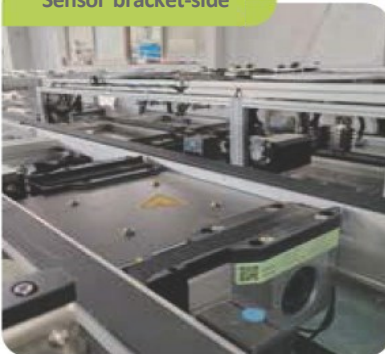

Sensor bracket-bottom

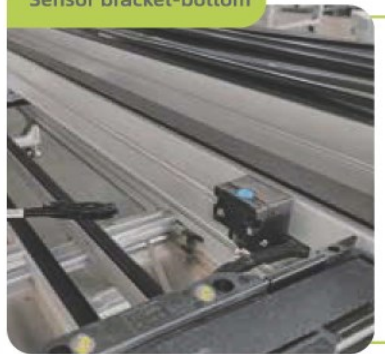



A Strategic Partner with



**Direct Conveyors** *(United States)*

**Phone**

(317) 346-7777

**Address**

551 Earlywood Dr.  
Franklin, IN 46131

**Website**

[Directconveyors.com](http://Directconveyors.com)